

ITEM 52. PARKING – NO PARKING – PITT STREET SYDNEY

TRIM RECORD NO: 2015/498201

RECOMMENDATION

It is recommended that the Committee endorse the reallocation of kerb space on the western side of Pitt Street, Sydney north of Wilmot Street as follows:

- (A) Between the points 0 metres and 10 metres north of Wilmot Street as “No Stopping”;
- (B) Between the points 10 metres and 25 metres (two car spaces) north of Wilmot Street as “No Parking Coaches Excepted 15 Minute Limit”;
- (C) Between the points 25 metres and 35 metres (two car spaces) north of Wilmot Street as “Taxi Zone”; and
- (D) Between the points 35 metres and 49.6 metres (two car spaces) north of Wilmot Street as “No Parking”.

DECISION

BACKGROUND

Development Consent Conditions 34 and 39 of Development Application D/2013/1822 requires the Greenland Group, the Developer of 115-119 Bathurst Street, Sydney, to submit for review by the Local Pedestrian, Cycling and Traffic Calming Committee (LPCTCC) a parking plan for the Pitt Street frontage of their development.

COMMENTS

The kerb space on the western side of Pitt Street, Sydney between Wilmot and Bathurst Streets is currently signposted as ticket parking, a Works Zone and a Bus Zone. A ticketed “Loading Zone” was in operation prior to the introduction of the temporary Works Zone.

The proposed parking changes would facilitate pick-up and drop-off activities for the future hotel at the site.

The proposed parking changes were discussed and granted ‘in principle’ support from the CBD Transport Taskforce.

CONSULTATION

Consultation with nearby properties was undertaken as part of the Development Application process for 115-119 Bathurst Street, Sydney.

FINANCIAL

All costs associated with the proposed parking changes will be borne by the Applicant.

ATTACHMENTS

Parking – No Parking – Pitt Street Sydney

Eoin Cunningham, Senior Traffic Engineer

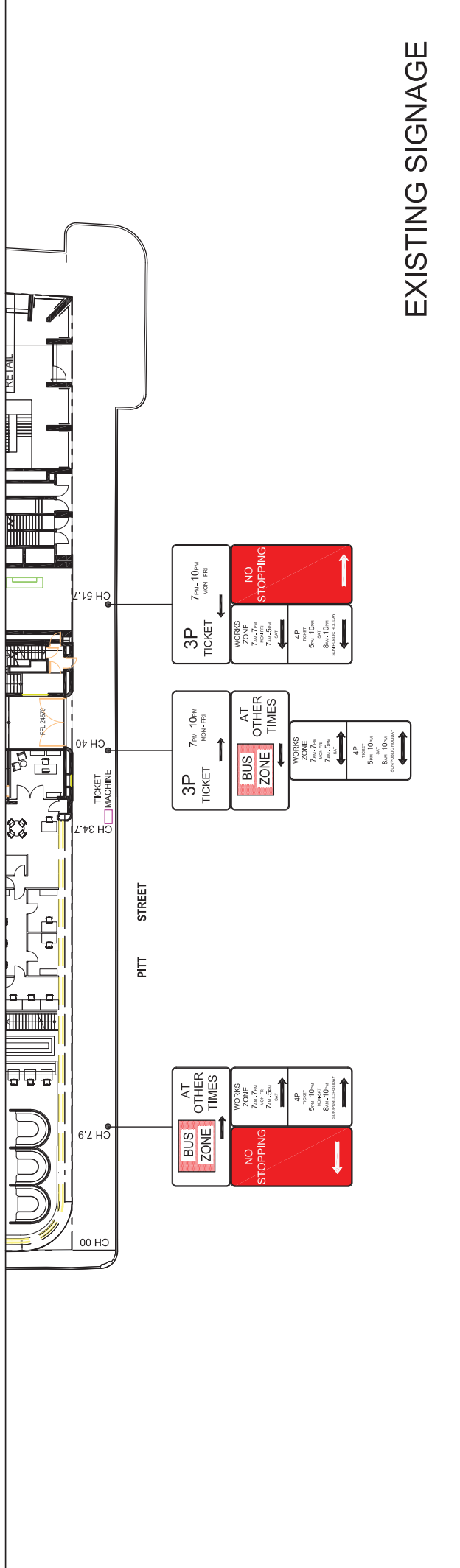

EXISTING SIGNAGE

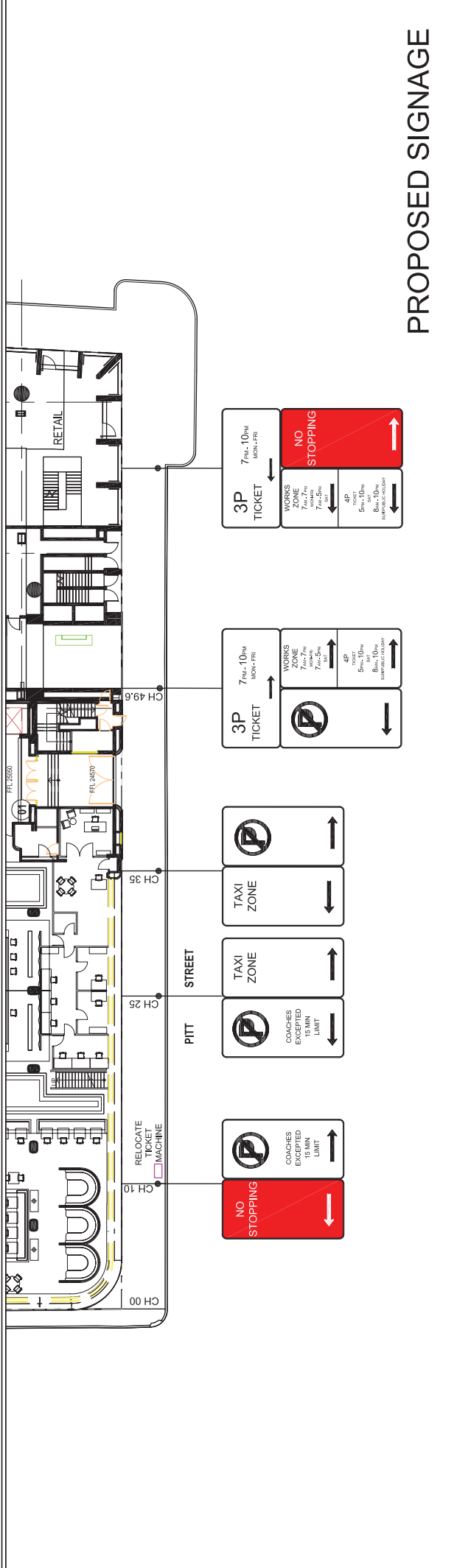

PROPOSED SIGNAGE

LEGEND

**EXISTING AND
PROPOSED SIGNAGE**

